

ENDLESS SUMMER







COMFORT AT REST

Experience the zero speed stabilizer technology. Feel the comfort and balance even at rest with the "zero speed stabilizers" together with the unsurpassed luxury and privacy Endless Summer is equipped with.

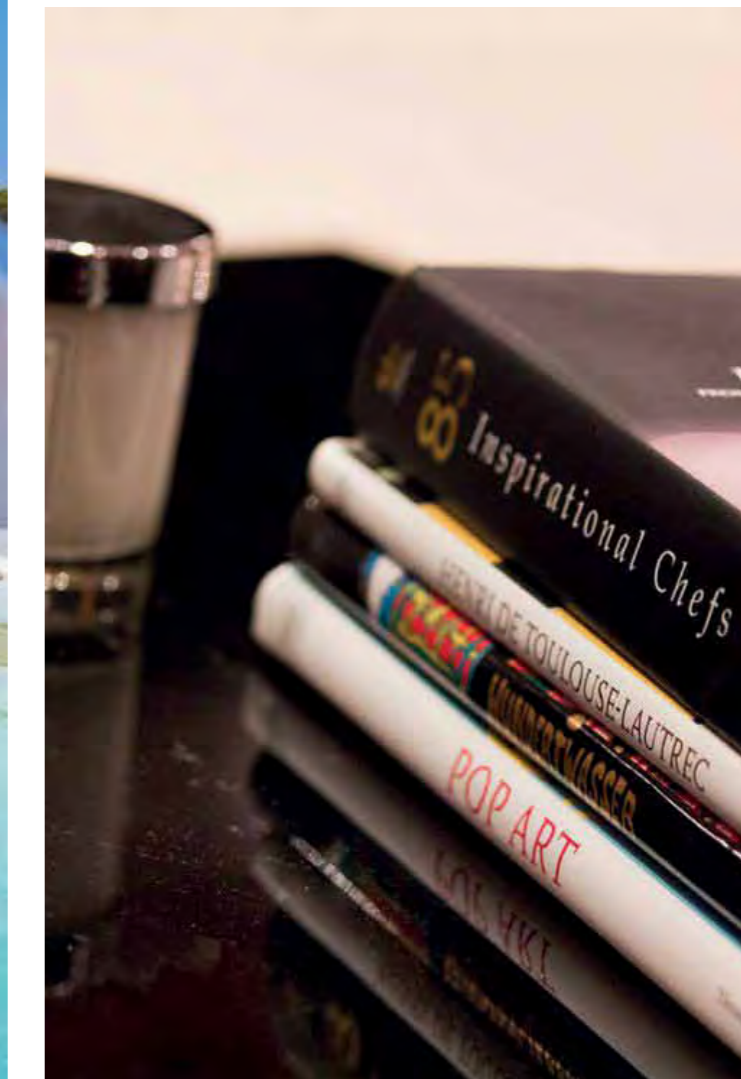

Zero Speed Stabilizers



FLYING BRIDGE

The flying bridge is an exceptional place of the yacht where you can live the experience of navigation in the open air. Its comfortable seats makes your cruising a unique experience.

Cruising begins



AllYachtsWorldwide.com

MAIN DECK

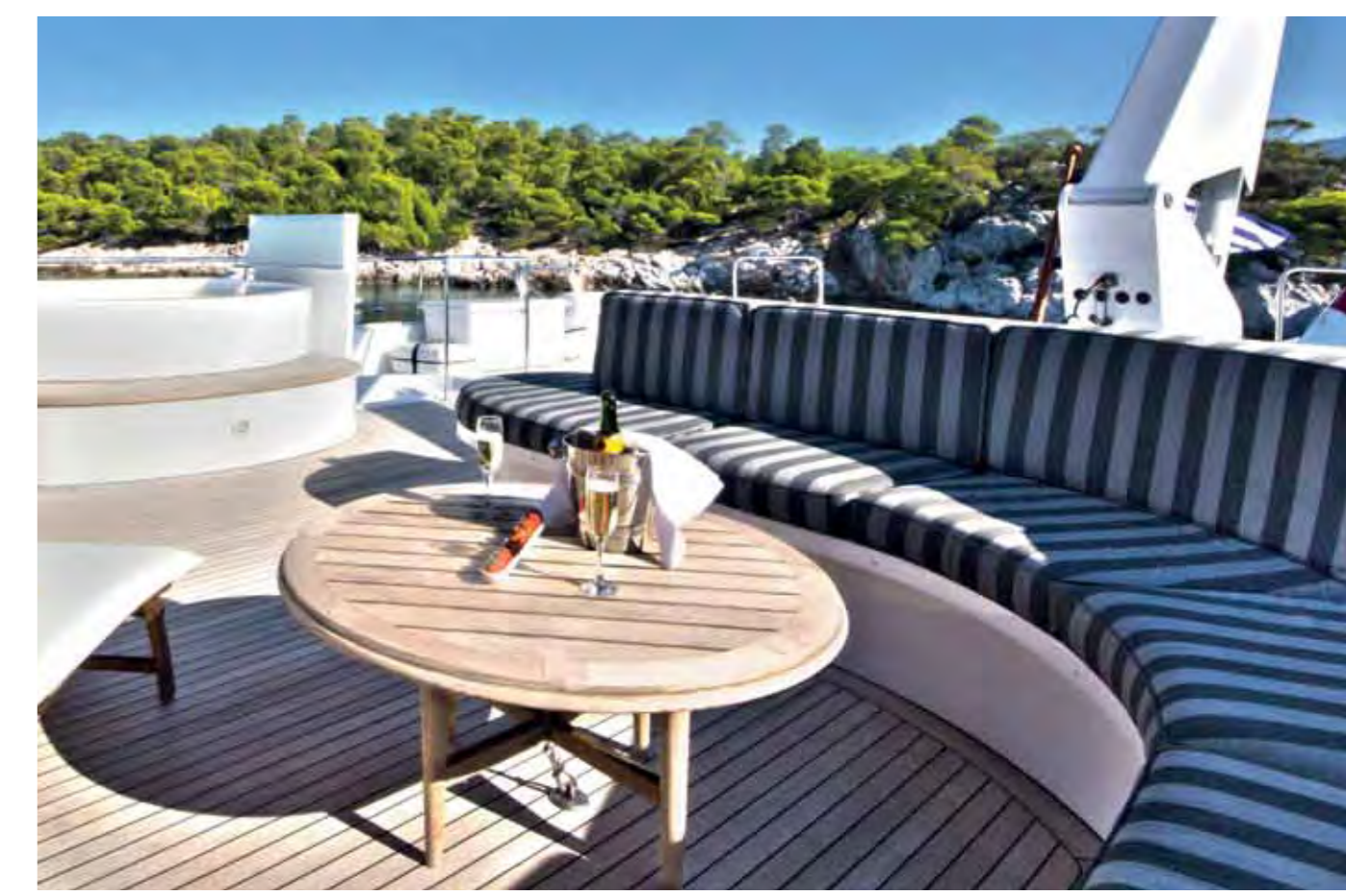

Guests may try various delicious eatings on a comfortable couch and a wide table on the mid deck. The excellent taste that you will get is supplemented by the sense of well being. Relish every hour of the day, as being part of your entire enjoyment.

Enjoy your day under the blue sky

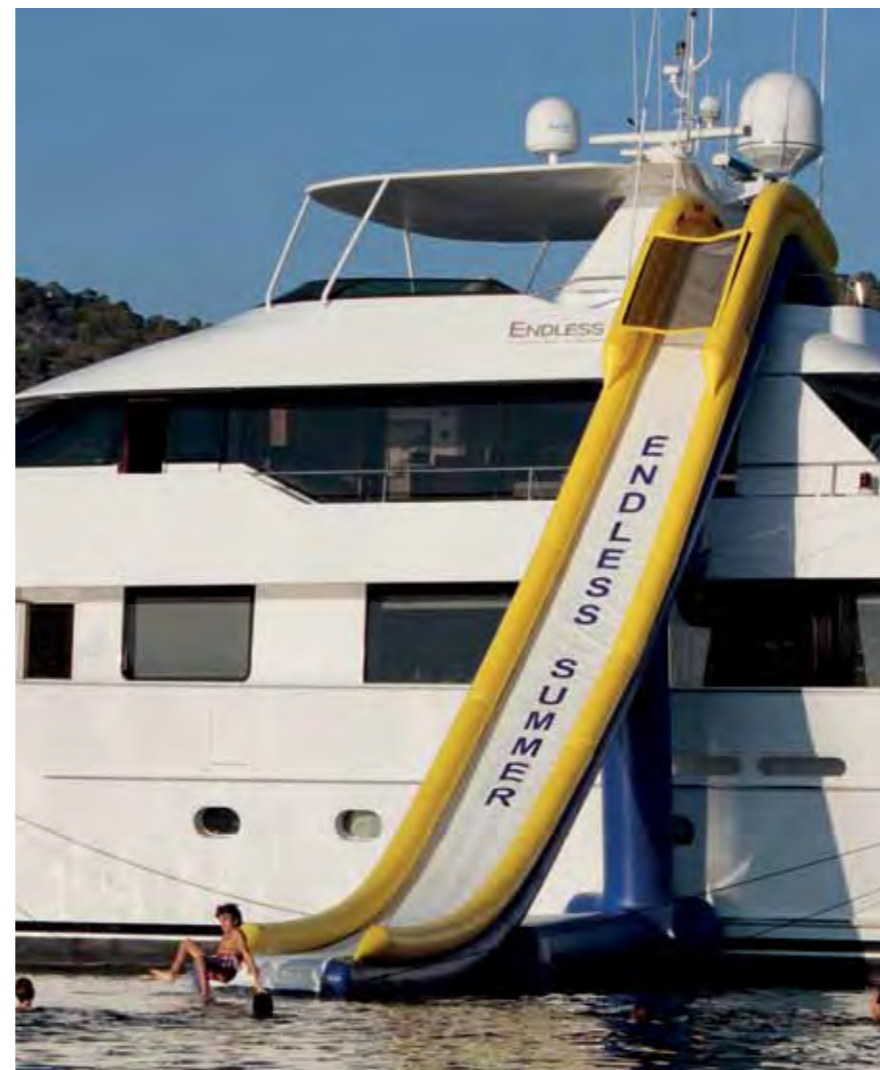

OUTDOOR ACTIVITIES & SEA TOYS



Enjoy spa and have fun

During your delightful cruise an outdoor Jacuzzi under the sky at the top deck of the yacht and plenty of fascinating activities can ensure moments of excitement. A pleasure boat for small escapes at the coast, a water slide, jet-skiing, skiing, diving, and canoeing are the exhilarating experiences that you can gain. For those of you who want to keep yourselves fit there is a treadmill and a spinning bicycle for working out.







MASTER CABIN



The master cabin of the yacht is the absolute place of comfort and relaxation. It has a centerlined king bed, surrounded by elegant furniture of fine wood that can be used as a boudoir or office space and separate 'His' and 'Her' bath entries. Due to the magnificent panoramic view to the sea this is the place where you will love to be.

Love the luxury

DINNER AT DECK



The sun has set and the open-air lifestyle on board is featured by charm and pleasurable dinners. Endless Summer can be transferred from an absolute cruising experience to an ideal place where guests can dine under the stars in pure delight.



Let the stars sparkle your taste





DETAILS



Guests can enjoy enchanting moments surrounded by selectively chosen and exquisite details; a pleasure for the eyes with aesthetics at its best. You can spend pleasurable time entertaining yourself with several activities in each of the three decks of the yacht.

Luxury in essence



Specifications

Overview

Type	Tri Deck Motor Yacht		
Length	130' / 39.6 m	Beam	26" / 8.0 m
Draft	6'6" / 1.9 m	Height	36' / 10.9m
Designer	Westport		
Speeds	From 12 knots up to 24 knots. The yacht can cruise as displacement or as a planning yacht 12 24 Knots Cruise/27 Knots Maximum*		
Range	3450 nmiles @ 12 kts		
Main Engines	Twin MTU 12V4000 / 2735 hp each @ 2150 Max RPM		
Generators	1 x Onan 100 kw + 1 x Onan 75 kw		
Stabilizers	Naiad Zero Speed		
Watermakers	2 x Sea Recovery 1200 gallon per day (2 x 4550 liters per day)		
Fuel	9900 gals / 37472 ltrs	Water	1620 gals / 6132 ltrs
Displacement	370,000 lbs 168 000 kgs	Tonnage	307 (ITC)

* Speeds/Ranges Are Approx. Subject to Load, Sea Conditions, & Variables

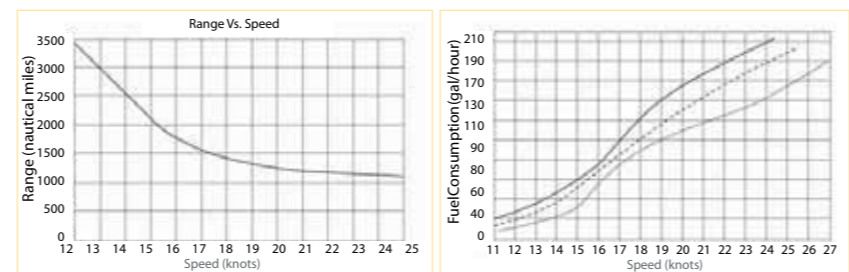

Accommodations

Sleeps 10	Crew 7
	Up To Ten Guests in one Master Suite, Two Equal Queen Suites and Two Twins. Crew Quarters for Up To Eight, Including Captain, in Four Cabins all with Ensuite Bath Facilities.
Master Stateroom	The Master cabin is located on the Main deck, forward and spans the full width of the yacht. The suite has a king size bed, full width His and Hers marble en suite bathroom with Jacuzzi tub and shower.
VIP Staterooms	The VIP Stateroom Port has a Queen bed, marble ensuite bathroom with shower. Another VIP cabin to the Starboard is identical to the port cabin with a Queen bed.
Port Starboard Guest	The 2 remaining cabins are located to the port and starboard amidships and have two twin beds each and marble ensuite bathrooms with shower.
Crew Quarters	Four staterooms, each with private bath facilities.
Interior Woods	Cherry with Madrona Burl.

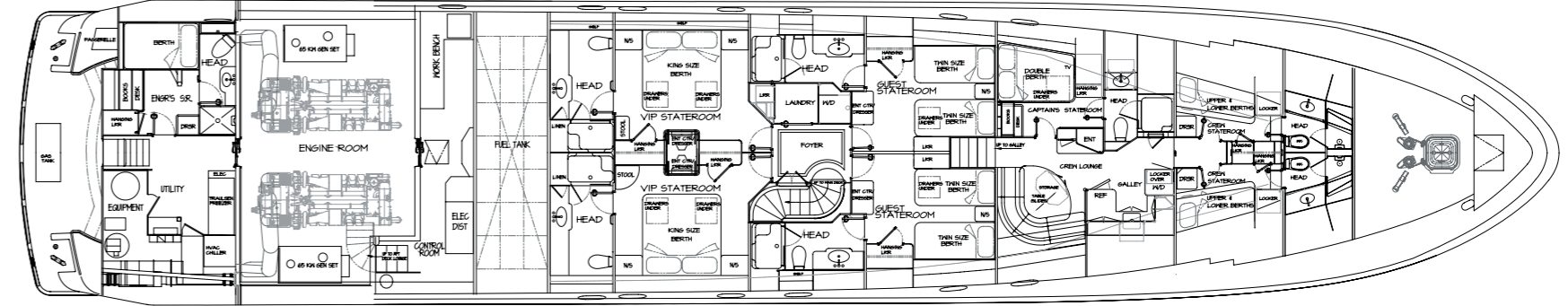
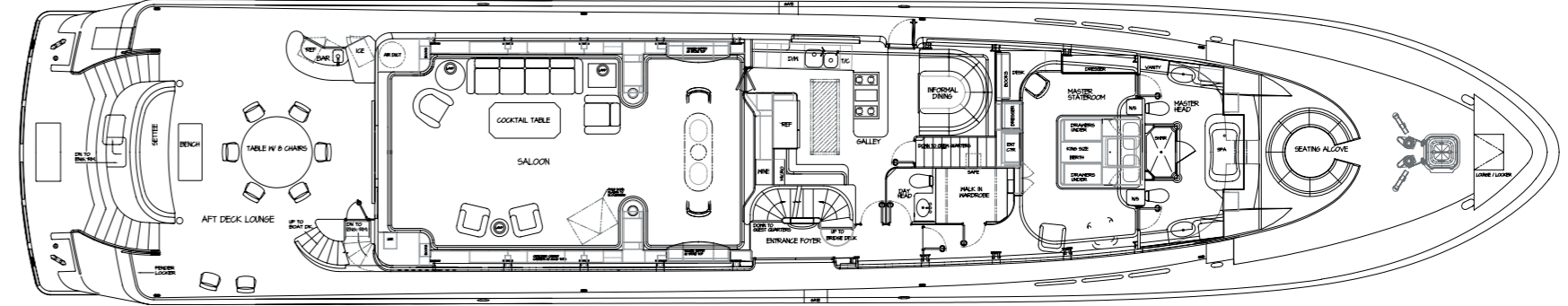
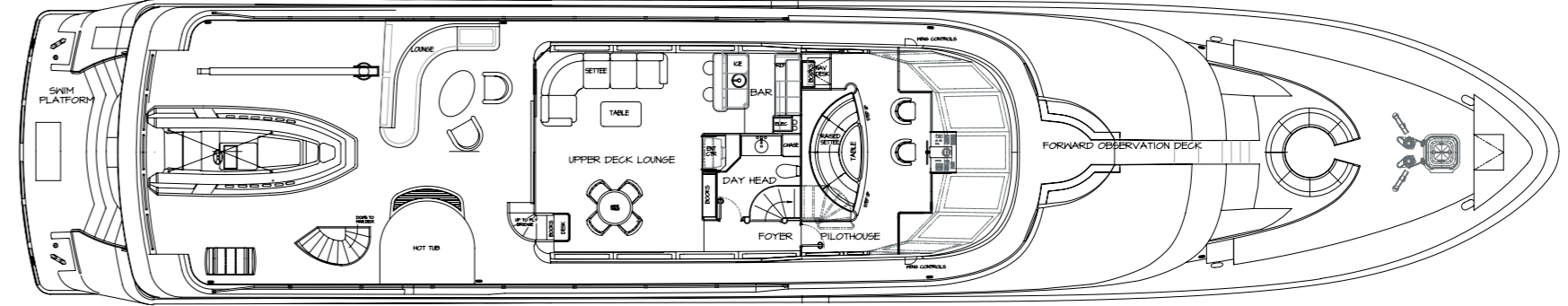
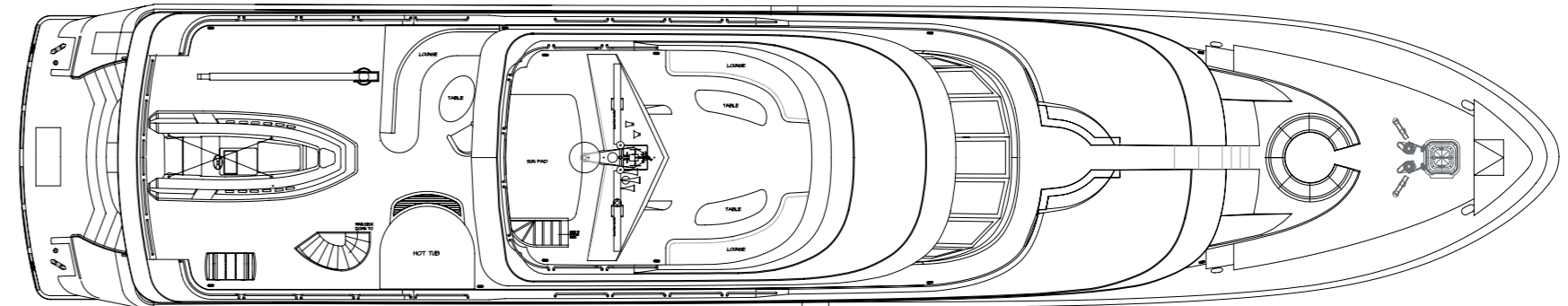
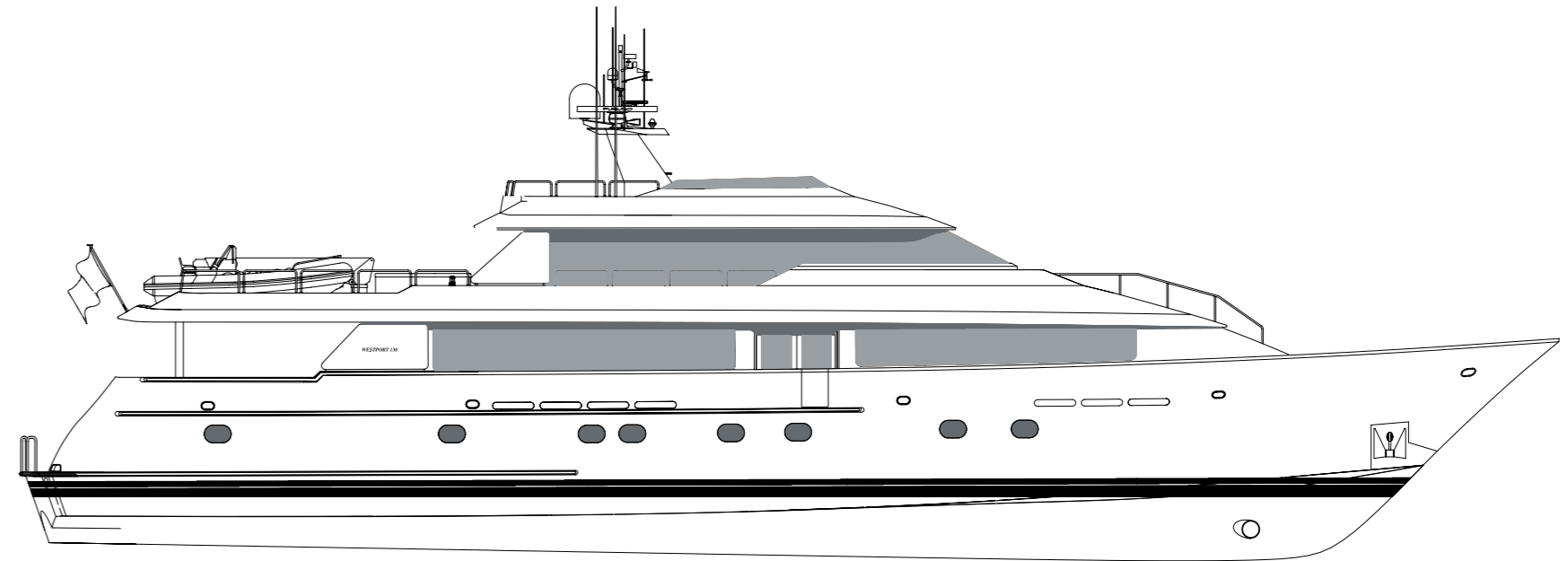



AllYachtsWorldwide.com

ENDLESS SUMMER