

# LADY LEILA





Aft Deck Dining



Main Salon



Dining



Galley



Main Deck Foyer



Main Deck Master



Main Deck Master en-suite





Guest Stateroom Foyer



VIP Convertible



Guest Double



Guest Double en-suite



Owner/Upper Deck lounging



Upper Deck Aft...view fwd to Upper Deck Master



Upper Deck Master



Upper Deck en-suite





Upper Deck Master Office



Bridge



Sun Deck Bar



Jacuzzi



Sun Deck Aft



Sun Deck fwd view



Sun Deck Dining Aft



Sun Deck Detail





Tenders & Toys



WaveRunners



LADY LEILA Underway....

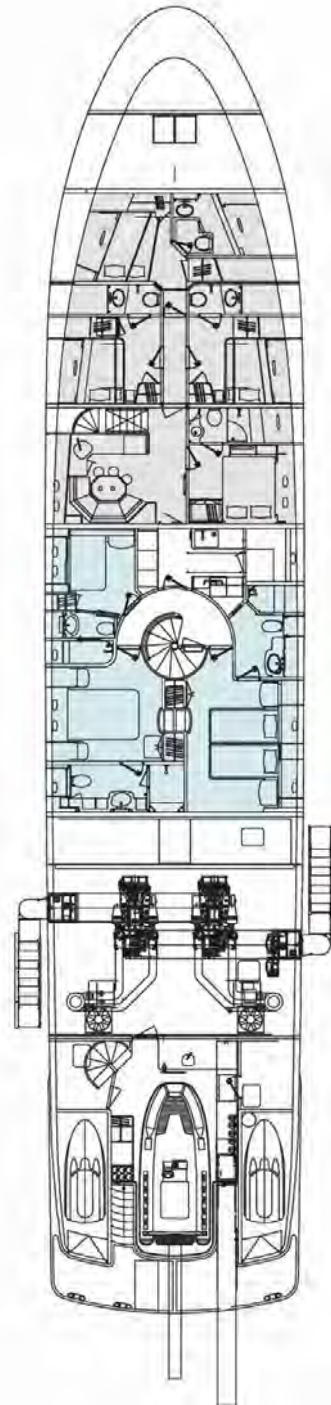
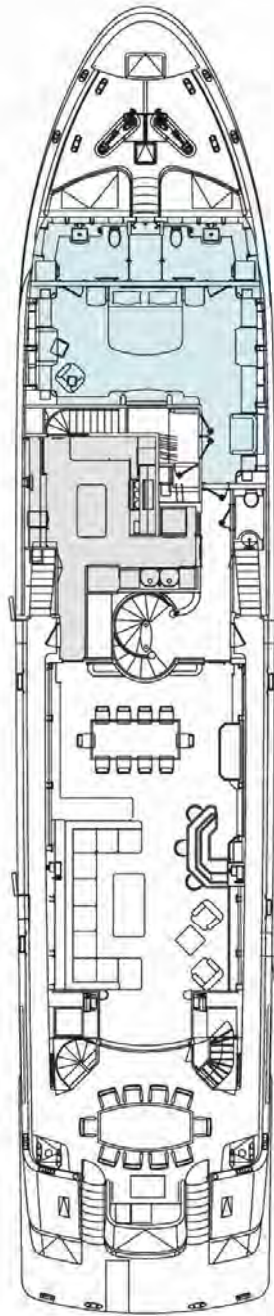
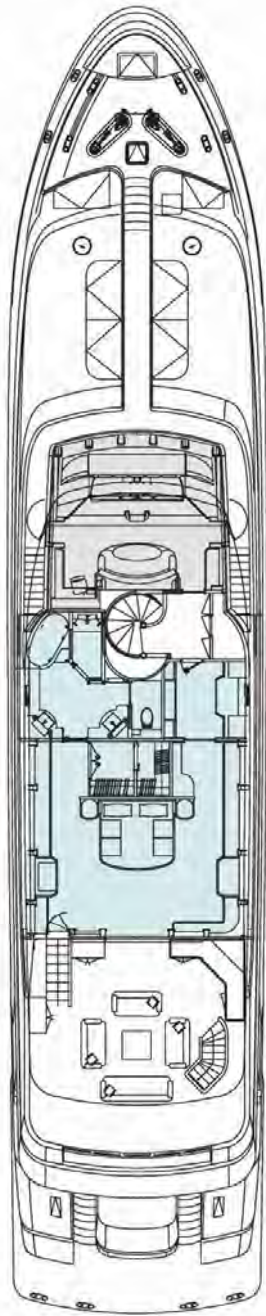
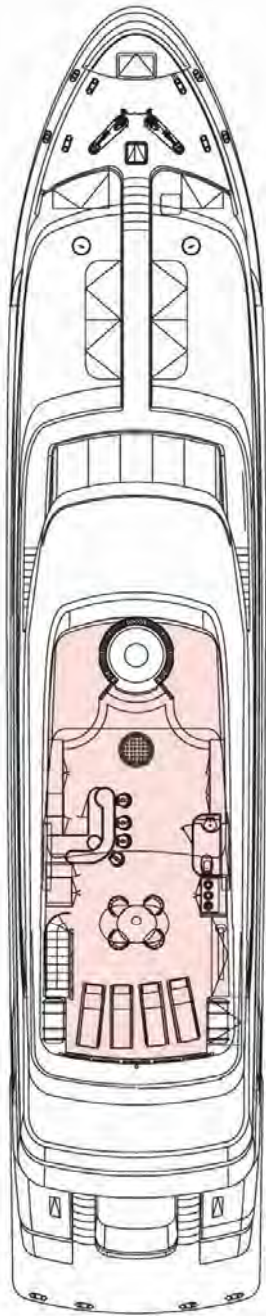

# LADY LEILA – Designed without compromise

---

## Length

40.2m (132ft)

## Built

2008, Horizon Yachts, Taiwan

## Cruising Speed

11 knots

## Guests

9/10

2 x Master cabins, main deck fwd & upper deck aft

1x Queen double cabin

1 x King double cabin, which converts to a twin

1 x Single cabin with a Pullman berth

## Crew

Captain plus 6 crew

## Watersports

377 Cubby Intrepid, 37' with triple Mercury Verado engines each 300 hp

4.9m (15.7ft) Castoldi diesel jet tender with 125hp engine

2 x Yamaha wave runner FX Cruisers (2 man)

2 x Kayaks

2 x sets water skis and tows

1 x Wake board

1 x Knee board

Dive compressor and scuba tanks (rendezvous diving only)

Snorkelling equipment

Fishing gear

## Audio Visual and Communications Equipment

Upgraded A/V, Kaleidescape system

Fleet 77, VSAT – 24/7 unlimited data

High speed Wi-Fi & iPod docking stations

Satellite TV with new HD televisions throughout

**LADY LEILA has a warm, elegantly appointed interior with exquisite woodwork throughout and uniquely features 2 luxurious master staterooms. The inviting sundeck has plenty of space to bask in the sunshine, cool off in the Jacuzzi or dine with panoramic views. For the more active, there are plenty of toys and activities for maximum enjoyment.**

All particulars are believed to be correct but cannot be guaranteed