

MILK & HONEY

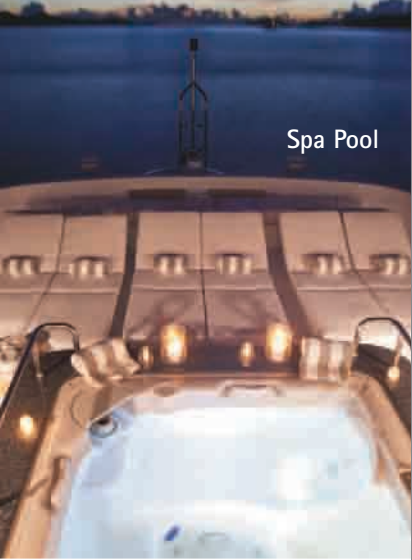

Your private oasis of privilege and plenty



Spa Pool



Sun Deck



Bar and Spa Pool





Paradise

Amazing SPACES

Milk & Honey will envelop you in privilege and style. With the spaciousness of a yacht of at least 150 feet, this finely built, 125-foot Palmer Johnson tri-deck motor yacht offers an abundance of beautiful settings in which to relax.

Chilled martinis by the spa pool? Just say the word. An afternoon in a chaise longue that adjusts to face the sun or shade and converts to oversized sunpads? Your spot awaits you. Intimate dinner parties by candlelight or under the stars? Your personal chef stands ready to grant your culinary wishes.

All this and much more will be yours as Milk & Honey transports you to stunning and exotic destinations. With Zero-Speed Stabilizers, complete indoor climate control, the latest in entertainment systems, and more, it's clear your comfort and pleasure are top priority on Milk & Honey.



Rare LUXURIES

The interior of Milk & Honey blends refined tradition with sleek furnishings in supple fabrics and serene colors. A multitude of windows allows in plenty of natural light while maintaining your privacy. Paneling and floors fashioned from rich cherry, mahogany, burlled olive, and inlaid black walnut are enhanced by fine paintings of soothing seascapes.

The stunning sky lounge is reminiscent of an exclusive gentlemen's club with wet bar, humidor, and chilled wine storage for 130 bottles. Large windows frame panoramic daytime views, while a 55" 3D HD TV provides evening entertainment.





Indulgence



Foredeck

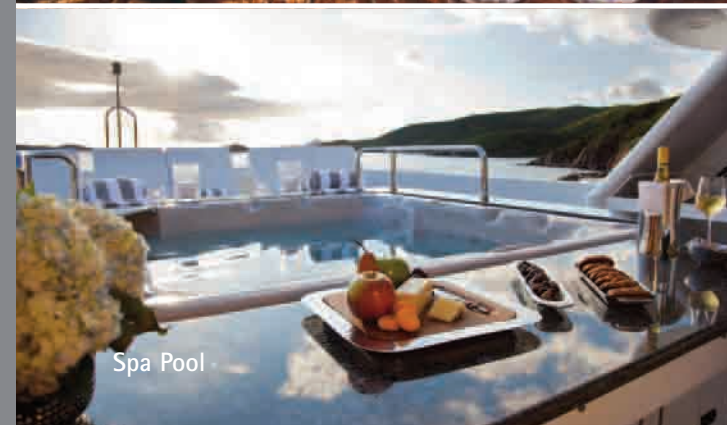

Spa Pool



Dining Salon



Main Salon



Abundance

Stylish PLEASURES

Unwind in Milk & Honey's grand salon, with its ample settee and chairs, full bar, and hide-away 3D HD flat-screen TV. According to your mood, meals may be served in the formal dining salon or al fresco at large tables located on both the main and the boat deck.



Aft Main Deck



Aft Boat Deck

Private HAVENS

Time to retire to your stateroom for a refreshing nap or a wonderful night's sleep? Milk & Honey's capacious and comfortable guest accommodations were made for complete rest and restoration. On the main deck, the full-beam master suite, with centerline king-size bed, encompasses a private office and his-and-her vanities connecting to a steam shower and oversized tub.



Master Bath



Serenity





Twin Stateroom



Queen Stateroom #1



Bliss

Queen Stateroom #1

Sweet DREAMS

On the lower deck, four additional staterooms are fully appointed with thoughtful amenities. There are three queen staterooms and one twin stateroom, all with en suite bathrooms. You'll sleep peacefully on Milk & Honey, knowing you've finally found the place where the very best dreams come true.

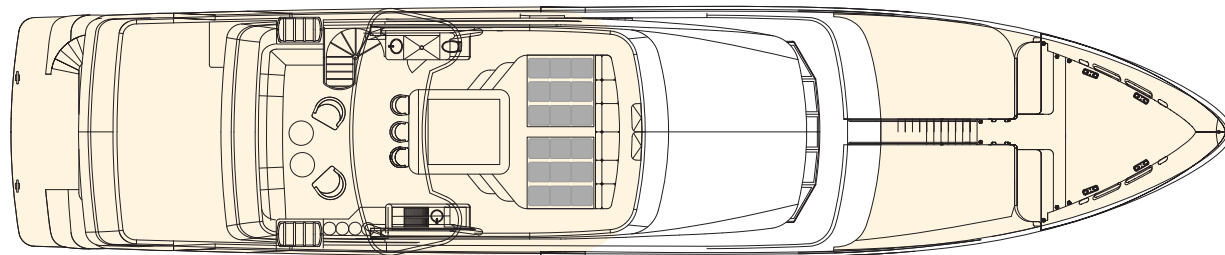

Sun Deck

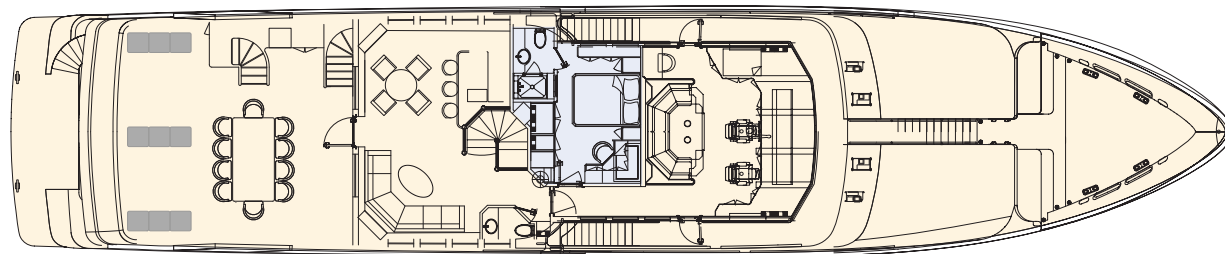

Boat Deck

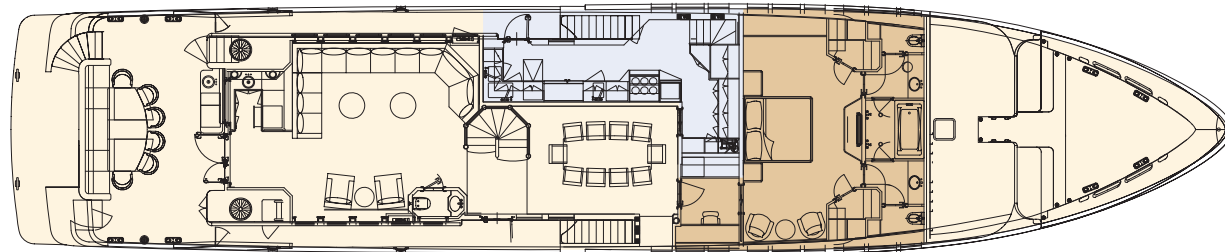

Main Deck

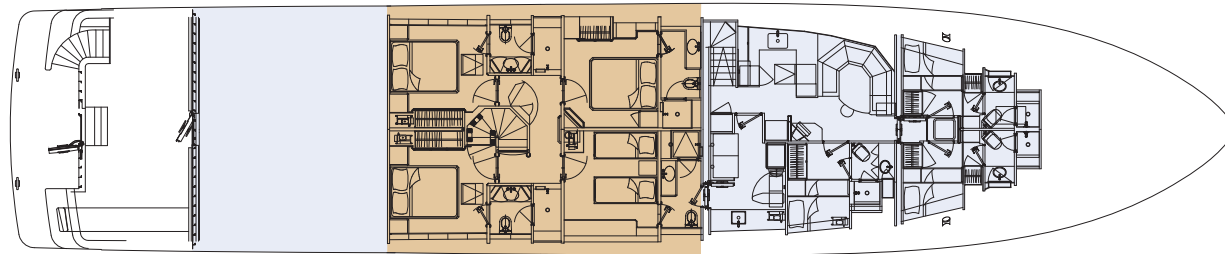

Lower Deck

Social Areas
 Guest Staterooms
 Crew Quarters

Discover the Land of Milk & Honey

Specifications

Built by Palmer Johnson
Launched 2003 • Full refit 2012
Continually maintained to the highest standards
MCA Compliant /
Germanischer Lloyd Classed 100 A5 MC
Length: 125 feet
Beam: 26 feet 6 inches
Draft: 9 feet
Cruising speed: 11.5 knots
Hull: aluminum
Fuel capacity: 12,460 gallons
Water capacity: 1,800 gallons
plus 3,200 gallons/day from 2 watermakers

Accommodations

For ten guests in five en suite staterooms:
one king, three queens, and one twin

Comfort & Leisure

Quantum Zero-Speed Stabilizers
Three kayaks
Selection of towable toys
Snorkel gear
Fishing tackle
SCUBA gear (for certified divers only)
Large 3D HD flat-screen TVs
Full entertainment system
DVD and CD library
Satellite internet access
Heated spa pool

Crew

Captain, Engineer, Mate, Chef,
2 Stewardesses, Deckhand