

SARITA SI



www.AllYachtsWorldwide.com



www.AllYachtsWorldwide.com



www.AllYachtsWorldwide.com

WELCOME ABOARD.....

Saxia Si is different from any other yacht, and will seduce you the moment you set foot on her.

This CRN classic built in 1973, has been metamorphosed by her present Owner into a genuine Gentleman's yacht.

She charms you in the true sense of the word, taking you

in other times and other places thanks to her superb

decoration created by a renowned Hollywood interior

designer. Her sophisticated ambiance is aided by an

abundance of natural and subtle interior lighting throughout

the yacht. Serious fun is also guaranteed onboard, offering

the very latest water sport equipment.

You can count on the assistance of a dedicated crew on

the swimming platform.

Step on board, let the magic of *Saxia Si*

overwhelm you, and allow the highly professional Captain

and his crew to pamper you.



SARITA SI



www.AllYachtsWorldwide.com

MAIN AFT DECK DINING TABLE



Sarita Si's deck space is impressive. By relocating the ship's tenders forward, the upper deck has been transformed into one of the most spacious and versatile areas of any yacht of her size. A large teak table on the main deck aft invites for dining alfresco with twelve guests, to enjoy the chef's gastronomic masterpieces.

www.AllYachtsWorldwide.com

BRIDGE DECK WITH JACUZZI



Enjoy the privacy of the sun deck, relax in the chaise lounges on the very spacious upper deck, where cocktail parties for fifty guests can easily be held or meals be served for twelve at the sheltered teak table.

www.AllYachtsWorldwide.com

MAIN SALOON



The incredible warmth of *Saxica Si*'s main salon created by the mahogany woodwork, the amazing ceiling, the inviting leather sofas, the quality of the light and

www.AllYachtsWorldwide.com

MAIN SALOON



the state of art entertainment system provide the ideal setting for relaxation. The low tables can both be converted to dining tables

www.AllYachtsWorldwide.com

MASTER STATEROOM



Located on the lower deck, *Saxila Si*'s Owner Stateroom reflects the same warm and incredibly comfortable atmosphere as the salon, featuring a king size bed, a sofa, a large desk, a large flat screen TV with DVD and a bathroom ensuite.

www.AllYachtsWorldwide.com

MASTER BATHROOM and ENTRANCE



VIP STATEROOM



Sarita Si's King VIP stateroom is situated forward on the main deck and offers the same beautiful features as the Owner Stateroom.

www.AllYachtsWorldwide.com

GUEST ACCOMMODATION



The other four guest accommodation, all ensuite, are located forward to the Owner Stateroom on the lower deck with two Twin cabins to starboard and a Queen plus a Twin cabin to portside.

www.AllYachtsWorldwide.com

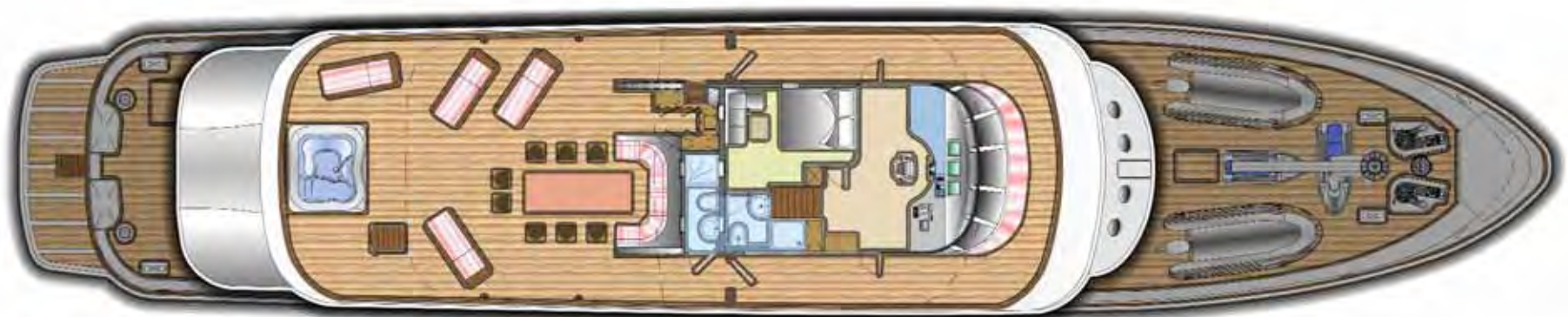

UpperDeck



S A R I T A S I

MAIN CHARACTERISTICS

| | |
|---------------------|------------------|
| Length overall : | 40 m (130') |
| Beam : | 7.20 m (23'7") |
| Draft : | 2.10 m (6'10") |
| Gross tonnage : | 227 tons |
| Classification : | RINA |
| MCA Status: | Compliant |
| Flag : | UK |
| Year built : | 1973 |
| Refit : | 2010 |
| Builder : | CRN Ancona |
| Interior Designer : | LM Pagano (2004) |

CONSTRUCTION

| | |
|---------------------|----------------|
| Hull construction : | Steel |
| Superstructure : | Steel /Alumium |
| Decks : | Teak |

ENGINES & GENERATORS

| | |
|-------------|-----------------------|
| Engines | 2 x Caterpillar 895hp |
| Generators: | 2 x Kohler 70 Kw |

ANCILLARY EQUIPMENT

| | |
|--------------------|--------------------|
| Air conditioning : | Condaria |
| Bowthruster : | Quantum |
| Stabilizers : | Quantum Zero Speed |

SPEED & RANGE

| | |
|------------------------------|----------------------|
| Maximum speed/ consumption: | 13 knots @400lph |
| Cruising speed/ consumption: | 11.5 knots @ 250 lph |

TANK CAPACITY

| | |
|-------------|------------------------------------|
| Fuel | 12,152 gal/ 46,000 ltr |
| Water | 2,642 gal/ 10,000 ltr |
| Watermakers | 12,960 ltr. p/d (3400 gallons p/d) |
| | 5,760 ltr. p/d (1,521 gallons p/d) |



Main Deck



Lower Deck

COMMUNICATION EQUIPMENT

| | |
|----------------|------------|
| Satcom | Mini M |
| Internal phone | Panasonic |
| Voip | V Sat |
| WIFI | throughout |

NAVIGATION EQUIPMENT

| | |
|-----------------|------------------|
| Autopilot | Robertson |
| Echo sounder | Furuno |
| Weather Station | Furuno / Airmar |
| GPS | Furuno/Raymarine |
| Radar | Furuno x 2 |

Electronic Chart System: Transas

VHF, HF and DSC Sailor

SAFETY / SECURITY EQUIPMENT

Liferaft RFD 2x20man, RFD 2x12man

Fire fighting equipment: Fully MCA compliant

TENDERS & WATER TOYS

Tenders (2) 1 x 6,4 m - 1 x 4,5 m

Wave Runners 2 x Yamaha Fx Series

Water toys Kayaks x 2 ,Molecule, Banana,

Power Snorkel (2 man), Snorkeling gear,

Sea Bob, Waterski's, Wake boards, etc.

ACCOMMODATION :

Total 12 guests maximum

Main Deck : VIP King with ensuite bathroom

Lower Deck Master King with ensuite bathroom

1 Queen + 3 Twins, all with ensuite bathroom

ENTERTAINMENT EQUIPMENT

Satelite TV, Blue Ray, DVD, I Pod sations, movie servers,

WII, Board Games, etc

Sarita Si



www.AllYachtsWorldwide.com